

PRE-CAST CONCRETE UNDERGROUND VAULT EQUAL TO OLD CASTLE VAULT AS SHOWN

BASE SECTION 5106-LA WITH 2 INCH FLOOR DRAIN EQUAL TO OLYMPIC FOUNDRY NO. 3206 CAST IN SUMP WITH 2 INCH CAST IRON PIPE EXTENDING OUT MINIMUM 12 INCHES BEYOND WALL IN DIRECTION REQUIRED.

58 INCH SECTION 5106-ML

LW PRODUCTS - TOP SECTION EQUAL TO 5106-TL-2-332P WITH DOUBLE ACCESS HATCH MODEL HHD-2-D, 42 x 72 OPENING AS SHOWN.

LADDER NO. 7 w/BILCO LADDERUP POLE REBAR RUNGS, 5/16" X 1-3/4" FLAT BAR RISER, WITH PROVISIONS TO ANCHOR AT TOP AND BOTTOM WITH 1/2 INCH ROUND CADMIUM PLATED BOLTS. LADDER ASSEMBLY, HOT DIP GALVANIZED AFTER FABRICATION, EQUAL TO UTILITY VAULT COMPANY STANDARD LADDER.

2" PRESSURE RELIEF ASSEMBLY

INSTALL 2" PRESSURE RELIEF VALVE, SCREWED EQUAL TO CLA-VAL NO. 50-01. PROVIDE MATERIAL SPECIFICATIONS FOR UHWA REVIEW AND APPROVAL.

2" GALV. IRON PIPE TO OUTSIDE OF CHAMBER.

2" RISER WITH 2" OPEN PATTERN RETURN BEND WITH 2" GALV. IRON PIPE 6" LONG, P.E. X THREADED (SET BOTTOM OF PIPE MIN. OF 24" ABOVE FINISHED GRADE).

INSTALL MIN. OF 1 UNION INSIDE OF CHAMBER.

INSTALL 2" GALV. IRON PIPE AND FITTINGS AS REQUIRED.

NOTE: LOCATION OF RISER SHALL BE DETERMINED IN FIELD BY THE ENGINEERS.

PRESSURE GAUGE ASSEMBLY

INSTALL 1/4" TEE HAND COCK, MARSH TYPE 1900.

INSTALL 1/4" PIG TAIL SIPHON, MARSH TYPE 38.

ONE 4-1/2" PRESSURE GAGE, MARSH TYPE 1, 0 TO 200 PSI.

ONE 4-1/2" PRESSURE GAGE, MARSH TYPE 1, 0 TO 60 PSI.

INSTALL ADDITIONAL PIPE AND FITTINGS AS REQUIRED.

ONE 6"x3/4" ROMAC SADDLE

PAINTING SCHEDULE

CONCRETE EXTERIORS BELOW GRADE

SURFACE SHALL BE CLEAN AND DRY. PAINT SIDES AND BOTTOM OF VAULT WITH TWO COATS OF TNE MEC PRIMER SERIES 46-465 COAL TAR SOLUTION (OR EQUAL) 8.0 TO 10.0 MILSDFT.

CONCRETE INTERIORS

WALLS AND CEILINGS - TWO (2) COATS OF PPG HPC INDUSTRIAL ALKYD 4308/DEVGUARD 4308
FLOORS - NONE.

METAL (EXCEPT FACTORY FINISH PAINTED EQUIPMENT)

ONE (1) SHOP COAT OF METAL PRIMER PPG PITT-TECH PLUS 4020 PF/DEVFLEX 4020 PF

TWO (2) COATS OF GROTTO BLUE PPG PITT-TECH PLUS 4016 HP/DEVFLEX 4216 HP

EXTERIOR DRAINAGE

CLEAN PEA GRAVEL UNDER VAULT TO SUPPORT @ 2% SLOPE. DRAIN ROCK AROUND PERIMETER OF VAULT SUBBASE. PERIMETER PERFORATED DRAIN PIPE AROUND SUBBASE OF VAULT, SLOPED TO SOUTH AND CONNECTED TO INTERNAL VAULT DRAIN DISCHARGE PIPE MINIMUM 20' FROM VAULT.

MATERIAL LIST

ITEM	DESCRIPTION
1.	6" x 2" SADDLE 202 IPT w/DOUBLE STAINLESS STEEL STRAPS
2.	6" GATE VALVE (FLxFL) w/HAND WHEEL (125 PSI)
3.	6" WYE STRAINER (FLxFL) w/STAINLESS STL SCREEN AND 1" BALL CORP
4.	6" DI SPOOL, FL x PE (CL 52)
5.	6" UNI-FLANGE
6.	6" COMBINATION PRESSURE REDUCING AND PRESSURE SUSTAINING VALVE EQUAL TO CLA-VAL 692-01 W/ STAINLESS STEEL TRIM & VALVE POSITION INDICATOR. PROVIDE MATERIAL SPECIFICATIONS FOR UHWA REVIEW AND APPROVAL.
7.	6" x 3" CROSS (FLxFL)
8.	PRESSURE GAUGE ASSEMBLY
9.	3" FLANGE w/2" IPT TAP
10.	2" BRASS BALL VALVE, IPT
11.	2" BRASS UNION
12.	2" BRASS SPOOL, LENGTH AS REQ'D
13.	2" 90° BRASS BEND
14.	2" WYE STRAINER w/STAINLESS STL SCREEN AND 3/4" BALL CORP
15.	2" SENSUS OMNI METER (SUPPLIED BY UHWA)
16.	ADJUSTABLE PIPE SADDLE SUPPORT (GRINNEL #264 OR EQUIV.)
17.	WALL FLANGE
18.	8"x6" REDUCER (RjxRj)
19.	FABRICATED ALUMINUM LADDER SECURED AT TOP AND BOTTOM w/ "BILCO LADDERUP" SAFETY POST ON LADDER - SEE DETAIL BELOW
20.	2" GALV. IRON PIPE, LENGTH AS REQ'D
21.	2" 90° BEND, GALV. IRON
22.	2" 90° STREET ELL, GALV. IRON
23.	2" PRESSURE REDUCING VALVE EQUAL TO CLA-VAL 90-01 W/ STAINLESS STEEL TRIM & VALVE POSITION INDICATOR
24.	4" PERFORATED SDR 35 D3034 PVC FOOTING DRAIN

ALL 3" AND LARGER PIPE AND FITTINGS TO BE DUCTILE IRON.
ALL BRASS FITTINGS SHALL BE LEAD FREE.

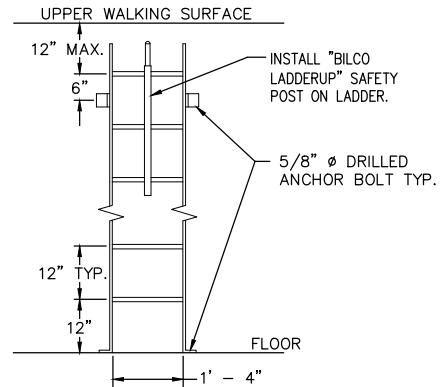

LADDER AND MOUNTING BOLTS SHALL BE CONSTRUCTED OF HOT DIPPED GALVANIZED STEEL. LOCATION TO BE DETERMINED IN FIELD.

LADDER DETAIL

N.T.S.

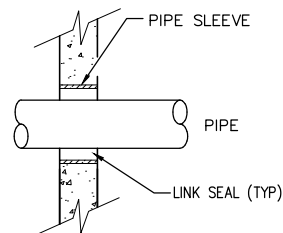

PIPE SLEEVE DETAIL

N.T.S.

6" PRESSURE REDUCING STATION

2 OF 2

UNION HILL
WATER ASSOCIATION

WATER STANDARD DETAIL
W-41

SCALE: NTS DATE: JUNE 10, 2019

R:\CAD\DETAIL\AUTOCAD\UHWA\W-41 6IN PRV